

# Arctic Fox



*Silver Fox Edition*  
*Aluminum SuperStructure*



[www.northwoodmfg.com](http://www.northwoodmfg.com)

# Welcome

Northwood is pleased to introduce the Arctic Fox Truck Camper. With nine plans to choose from, there is an Arctic Fox to fit the needs of nearly every camper buyer. You can purchase your Fox Camper with confidence because Northwood builds more slide out truck campers than any other manufacturer!

Arctic Fox offers a wide variety of features and options sure to satisfy your truck camper needs. That's because The Fox was designed with the informed camper purchaser in mind. We invite you to take a close look and you'll see why Arctic Fox is the camper of choice for the experienced buyer.



*Ron and Sherry Nash*

Built to withstand off-road use without leaving behind the comforts of home, the Arctic Fox Camper is the most popular full wall slide out truck camper on the market today.



*Model 990 \* Cactus*

# #1 Selling Slide-Out Camper

Our full wall slides are up to 26" deep, and our aluminum super structure slide out operates under heavier load conditions than competitors. Our transverse floor structure offers a wider main floor giving a spacious feel that is immediately apparent upon entering the coach.

When you compare the specifications of our slide out with the competition, you will see why Arctic Fox continues to be the industry leader. Arctic Fox is the leader in slide out truck camper design.

**Northwood sells more slide out truck campers than all other manufacturers combined!**



RV Consumer Group has given the Arctic Fox consistent high marks of Value and Reliability.

*\* Average rating of all models for Value, Reliability, and Highway Control* (Independent non-profit rating organization)



\* Average Rating of all models for Value, Reliability, and Highway Control (Independent non-profit rating organization)

*Form & Function: Interiors that work, beautifully!*



*Model 992 \* Chestnut*



*Model 811 \* Chestnut*



*Model 992 \* Taupe*

## Construction

Many manufacturers are building aluminum frame truck campers nowadays, but aluminum frames are not all the same. We are proud of the quality materials we use and the construction methods we employ to build America's best selling full wall slide out truck camper. There's no doubt that our Arctic Fox truck campers are attractive, but what really sets us apart from the competition is how beautifully

they're constructed. From our heavy gauge aluminum with continuous welded joints and solid fill anchor blocking, to our bonded full walk on roof that will support 26 employees, the Arctic Fox Truck Camper is truly a thing of beauty beyond it's good looks. Once you've owned an Arctic Fox, you'll never be satisfied with less. That's why we say... "Beauty is more than skin deep!"

*Arctic Fox*



*Model 990*



*Model 1150*



*Model 865*

## Full Walk-On Roof

When Northwood advertises a "Full Walk-On Roof" for our slide out truck campers, you not only can walk everywhere on the roof, but you could also invite a few of your friends to join you! We tested the strength of our full-wall slide 1150 model by filling the roof with 26 of our camper line associates and inviting them to pose for a picture.

*Now that's a FULL walk-on roof!*

# Comforts of Home

For years, Northwood has been the industry leader in slide out truck campers and this year is no exception! We will continue to lead the industry in innovative slide out camper engineering.

Like all Arctic Fox Campers, these new Foxes are durable enough for extended cross-country and off-road travel. We build our slide outs right, using dual ram rack and pinion slide mechanisms.

Many competitors rely on a single slide mechanism.

The dual rams carry the slide-out room smoothly even under full load weights.

Five separate seals insure against water intrusion. The slide room is completely insulated for your comfort in all weather conditions. You have your choice of a number of beautiful interior decor colors. Feature fabrics enhance

the Presidential Cherry finish hardwoods and textured wall boards. We use only commercial grade vinyl floor covering and you also have the option of a removable carpet kit. (Carpet kit not available in the 865, 992 & 1160 model.)



*Beauty: It's more than Skin Deep with Arctic Fox!*



*Model 811*



*Model 1140*



*Model 992*



Radius Backed Dinette \* Chestnut



Dinette with Overhead Bunk Option  
Nutmeg Interior no longer available



Typical Dry Bath

# Floorplans

We are proud to bring you a variety of big slide out camper options. Our full wall slides are up to 26" deep, (bigger than most of our competitors). Our aluminum super structure slide out will also operate under heavier load conditions than competitors. When you compare the specifications of our slide out with the competition, you will see why Arctic Fox continues to be the industry leader. (Model 865 is a non-slide camper.) Our transverse floor structure offers a wider main floor area giving the Arctic Fox Camper a spacious feel that is immediately apparent upon entering the coach.



Indicates pre wired locations where TV's can be installed

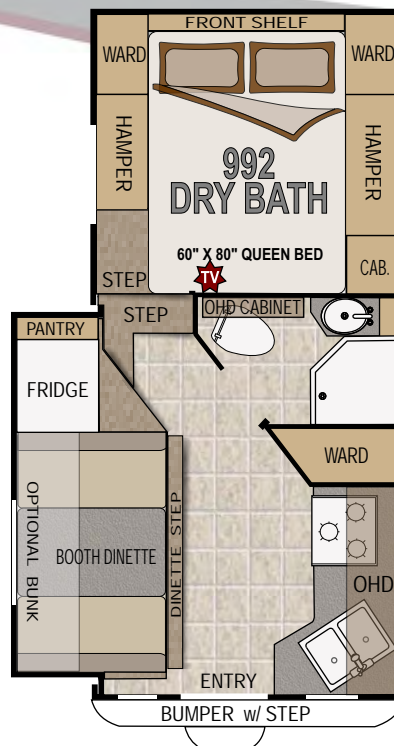

865 & 811 are available in short and long box models.



Typical Wet Bath



Model 990 \* Cactus



Model 992 \* Chestnut

# Arctic Fox

"Off Road Tough with the Comforts of Home"

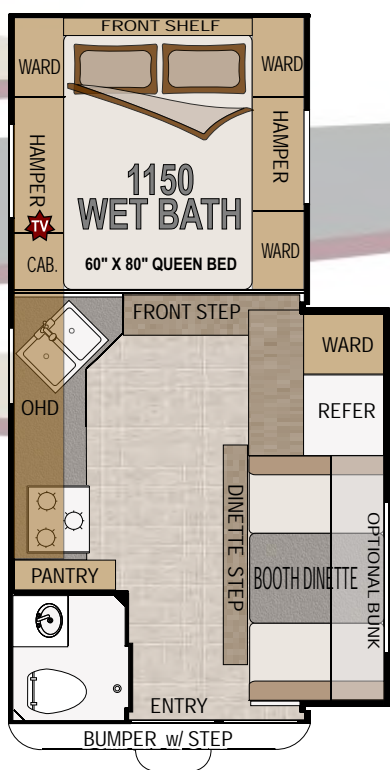

**TV**  
Indicates pre wired locations where TV's can be installed



To Be The #1 Selling Full Wall Slideout Camper  
Requires a #1 Quality Superstructure!

**ALUMINUM  
SUPERSTRUCTURE**

*Silver Fox Edition*

Rigid Foam Insulation Mounted in a Fully Welded Super Structure with 100% Bonded Lamination in All Walls, Floor, Roof.

Main Floor Nearly One Foot Wider Than Many Other Campers!

Huge Full Wall Slide with 43"x 78" Dinette  
(Available in Most Models)

Aluminum Floor Truss/Tank Support Design

Aircraft Construction Strong & Light!



Thick Wall Aluminum with  
Fully Welded Joints



*Silver Edition Solid Core Anchor Blocking Makes the Difference*

## Solid Core Anchor Blocking

Anchor blocking gives substantial strength at connection points while adding minimal weight to the frame.  
"It's the best 10 pounds you'll ever gain"

*Silver Fox Edition*

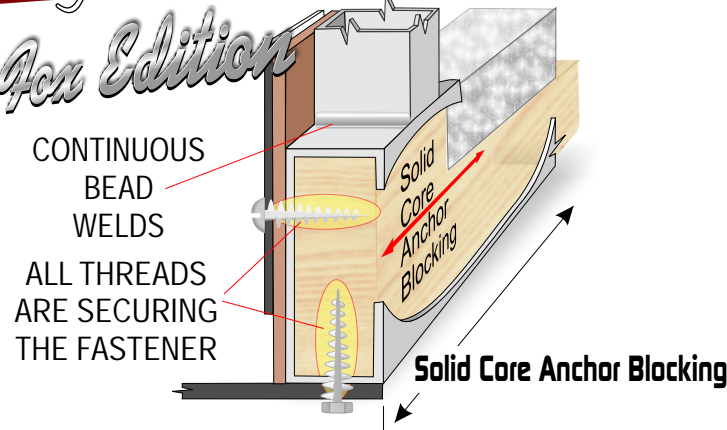

other brands

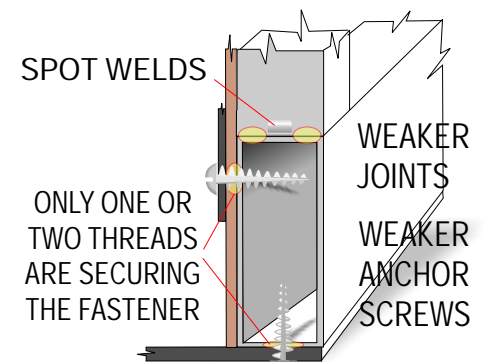



*Question:  
What is a Full Walk-On Roof?*



*Answer!  
(...is that Full Enough?)*



26 NORTHWOOD EMPLOYEES ON THE ROOF  
OF AN ARCTIC FOX 1150 TRUCK CAMPER!

*We Don't Just Stand Behind Our Campers..... We Can Stand On Them Too!*

When a camper manufacturer advertises...

**"Full Walk-On Roof"**, they mean that an individual can walk everywhere on the camper roof. When Northwood advertises a "Full Walk-On Roof" for our Arctic Fox slide out truck campers, you not only can walk everywhere on the roof, but you could also invite a few of your friends to join you! We tested the strength of our full-wall slide 1150 model by filling the roof with 26 of our camper line employees and asking them to pose for a picture.

### Now that's a **'FULL'** walk-on roof!

We don't recommend that you invite a couple of football teams to have a party on top your camper roof, but isn't it nice to know that your Arctic Fox can handle that load and any 'normal' loading situation.

Our Aluminum Superstructure and Hot Melt Lamination process provides the Arctic Fox with superb structural strength.

And because we apply continuous welds at every joint and use solid fill blocking at all key structural connections, our frames are stronger and threaded fasteners anchor firmly and completely.

# Here are 100 reasons to buy an Arctic Fox Camper



## Construction

Aluminum Superstructure  
 .060" - .125" Thick Main Members  
 3-1/2 - 1-1/2 Crowned Roof  
 2lb. Foam Block Insulation  
 Full Walk-On Roof  
 Transverse Floor / More Floor Space  
 Continuous 1 Piece Fiberglass Cabover  
 Rack and Pinion Slide Out Mechanism



## Exterior

Large Exterior Access Storage Compartments with All Metal Latches, Catches, Pulls and Automotive Bulb Seals Around All Doors  
 Dual Battery Compartment w/ Slideout Tray  
 Side Wall Diamond Plate Protection  
 Outdoor High Pressure Shower  
 4-Way Remote Power Jacks  
 5/8" Cast Iron Gas Line  
 Recessed Automotive Style Tail Lights  
 Rear Diamond Plate Protection  
 Large Rear Door View Window  
 Aluminum Dbl. Door Bumper w/ 3 Position Step Mount  
 Side Lights and Rear Light  
 Exterior Ladder and 7" Tall Roof Rack  
 Black Tank Flush & Large 7x8 Rear Awning  
 Thermal Pane Option  
 Exterior 110 Volt Outlets  
 Stand-up 7.5 Gal LP Tanks  
 Rain Gutters and Drip Spouts  
 White Frame Torque Windows  
 LP Hookup for BBQ & Rear Exterior Speakers



## Interior

Wood Face Frame Cabinet Construction with Shelves  
 Heated Enclosed Holding Tanks and Dump Valves  
 'FANTASTIC' Reversible Multi Speed Fan Vent  
 Standard Phone Jack  
 Solar and Satellite Ready  
 Power Converter with Charger & Charge Wizard  
 Direct Spark Ignition Gas/Electric Water Heater  
 Kenwood CD Player w/ 6 Speakers  
 Generator Ready (Most Models)  
 Generator Transfer Switch  
 Lambrequin Window Treatments  
 Night Shades on All Windows  
 Adjustable Heat Vent / Ducts  
 Convenient Monitor Panel  
 3 Interior Color Packages  
 Cabover Hampers  
 Rheostat Lighting  
 TV Antenna  
 Large Windows  
 Ozite Ceiling Liner  
 Recessed Lighting  
 Optional Carpet Kit  
 Wood Trim Accents  
 2 Fluorescent Lights  
 12 Volt Disconnect Switch  
 8-110 Volt Outlets (9 in Dry Bath Models)



## Kitchen

3 Burner Hi-Output Range w/ 22" Oven (most models)  
 Metal Ball Bearing Drawer Glides  
 Presidential Cherry Finish Cabinets  
 20 Mil Wear Surface Linoleum  
 Microwave  
 Solid Wood Doors  
 Variable Lighting  
 Counter Extension  
 Slide Out Pantry  
 6 CU FT. Refer w/ 2 Way-LP, AC  
 Auto Select Feature and 9 Temp. Settings  
 Large Kitchen Skylight  
 Residential Style Faucets  
 Single Lever Kitchen Faucet w/ Pullout Sprayer  
 Galley Backsplash

*Arctic Fox*



## Bathroom

Bathroom Skylight  
 Aux Clothes Hanger  
 Vanity Cabinet & Mirror  
 7 -110 Volt Outlets (8 in Dry Bath Models)  
 Freeze Resistant Waterlines  
 Fiberglass Shower Stall



## Bedroom

Coordinated Bedspread & Shams  
 7" Deluxe Inner Spring Mattress  
 Swivel Accent Spot Lights  
 Full Wall Wardrobe Option  
 Large Wardrobe Cabinet  
 Optional Front Window  
 Decorative Book Shelf  
 Mirrored Closets  
 Padded Headboard  
 TV Cabinet with:  
 110 Volt Outlets  
 12 Volt Outlets  
 Park Cable Connection  
 Amplified TV Antenna Hookup  
 20" Flat Panel TV Option



## Slide Out

Full Wall Slide  
 Under Step Storage  
 5 Seals on Slide-Out  
 Deep Under Seat Storage  
 Longer/Wider Dinette Table  
 26" Deep Slide (Most Models)  
 Dinette Converts to 43 x 76 Bed  
 High Density Foam Seat Cushions  
 Optional Fold Down Overhead Bunk w/ Pad



Photos in this brochure contain optional and standard items, and decor items. See dealer for specific information regarding standard equipment and optional features. Photos and drawings are representative of Northwood products and may differ slightly from actual production models. Northwood continually upgrades and improves its products and reserves the right to change specifications without notice. Check with your authorized dealer for update information. Northwood Manufacturing \* 59948 Downs Road \* PO Box 3359 \* La Grande, OR 97850 \* (541) 962-6274 \* www.northwoodmfg.com

## Arctic Fox Camper Safety Tips

Use **TORKLIFT** frame mounted camper tie downs for greatest safety.

For your safety while driving, use mirrors that allow you to view past the camper to the rear on both sides. Trucks can be purchased with extended mirror options or you may purchase mirror extensions.

Truck manufacturers state that you should not exceed the GVRW for the vehicle that carries your camper. The configuration of your truck will determine what size camper your vehicle can carry. A dual rear wheel truck is

advisable for Arctic Fox Campers over 10 ft. Adjustable air bags will help to level your vehicle transfer rear axle weight forward for comfort and safety and are recommended for all Arctic Fox applications.



## www.torklift.com

Some states allow passengers to ride in the camper, but it is not recommended as there are no seat belts available. When driving in any adverse weather condition it is always best to reduce your speed. The pickup should be outfitted with a durable rubber mat liner to reduce shifting while traveling. The mat will also protect the truck bed and camper from scratching while loading and unloading.

# Standard Features



Curtitian folding wall is standard with all Arctic Fox Campers.



Sliding Dual Battery Tray Holds Two Group 29 Batteries 420 Amp Total Capacity



Full Pressure Hot / Cold Exterior Wash Down Sprayer



Skylight w/ Shade Available

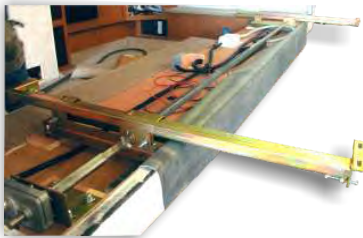

Dual or Multi Ram Rack and Pinion Slide Assembly in All Slide Outs



Extra Large 7' x 8' Rear Awning Standard on All Models



Diamond Plate Kick Panels. Storage in Bumper w/ Locking Doors at Both Ends.



Sliding Pull out Pantry Cabinet



Hide-Away Shower Screen completely stows away (1140 & 1150 drybath only)



Dual LPG Tanks w/Auto Change-over Regulator



Cable, Phone & Satellite Ready (All Models)



12 Volt Exterior Lighting at Patio w/ Interior Switch

Extra Large Holding Tanks with up to: (Underside view before trusses are installed.)  
55 Gal Fresh Capacity  
44 Gal Grey  
43 Gal Black



Aluminum Trusses Support All Tanks

Quick Connect LPG Hook-up for Barbeque and other Exterior Appliances



- \* Monitor Panel (Holding Tanks & Batteries)
- \* Generator Panel (optional-not pictured)
- \* AM/FM CD/DVD (CD / DVD optional)
- \* Solar Panel Monitor (optional-not pictured)



Warm Air Space

Fiberglass 3-1/2" Blanket Insulation

Fully Insulated Holding Tank Compartments

## A True 4-Season Coach

The Arctic Fox is a true 4-Season Truck Camper.

Our fully insulated holding tank area circulates warm air around the tanks providing the best protection from freezing. The tanks are large and will hold up to 55 gallons of fresh water, 44 gallons of gray water storage, and up to 43 gallons in the black storage tank. The black holding tank come with an internal sani-flush system for easy cleaning and maintenance.

Consistent 4-Star Rating

RV Consumer Group has given the Arctic Fox consistent high marks of Value and Reliability.



BY RV CONSUMER GROUP  
Average Rating of all models for Value, & Reliability  
(Independent non-profit rating organization)

## More Optional Features



Full Wall Wardrobe Cabinet available



Optional Front Window in Bedroom Suite and Diamond Plate on the Cab Over



Auto Scanning Satellite Dish (Option Available)



Combo Antenna/ Satellite Dish



Flat Panel TV (Option Available)

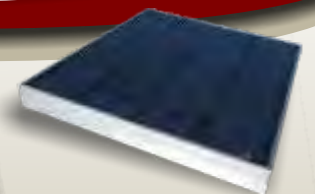

50 or 100 Watt Solar Panels (Option Available)

# Features and Options

Full 12 Month Warranty (All Models)

	811	865	990	992	1140	1150	1160
<b>CONSTRUCTION</b>							
Thermal Pane Windows	O	O	O	O	O	O	O
Storm Windows	O	O	O	O	O	O	O
Front Cab-Over Window	O	O	O	O	O	O	O
<b>ELECTRICAL</b>							
50 Watt Solar Panel w/ Controller	O	O	O	O	O	O	O
100 Watt Solar Panel w/ Controller	O	O	O	O	O	O	O
Combo Satellite Dish	O	O	O	O	O	O	O
Auto Scan Satellite Dish	O	O	O	O	O	O	O
2.5 Onan Generator (Short Box Only 865 / 811)	O	O	O	O	S	S	S
11K BTU Air Conditioner	O	O	O	O	O	O	O
<b>KITCHEN / GALLEY</b>							
2-way Double Door 6 Cu. Ft Fridge	S	S	S	S	O	S	N
2-way Double Door 8 Cu. Ft Fridge	N	N	N	N	S	N	S
3-way Double Door 6 Cu. Ft Fridge	O	O	O	O	O	O	O
3-way Double Door 8 Cu. Ft Fridge	N	N	N	N	N	O	N
3 Burner Range with 22" Oven	S	S	S	S	N	S	N
3 Burner Range with 16" Oven	N	N	N	N	S	N	S
<b>PLUMBING &amp; LAVY</b>							
Dry Bath	N	N	S	S	S	S	S
Wet Bath	S	S	S	N	O	O	N
DSI Gas Electric Water Heater	S	S	S	S	S	S	S
<b>INTERIOR</b>							
LCD Flat Screen TV	O	O	O	O	O	O	O
DVD Player	O	O	O	O	O	O	O
Overhead Bunk in Dinette	O	O	O	O	O	O	O
Full Wall Wardrobe	O	O	O	O	O	O	S
Removable Livingroom Carpet	O	N	O	N	O	O	N
<b>EXTERIOR</b>							
Diamond Plate Front Panel	O	O	O	O	O	O	O
Side Box Awning	O	O	O	O	O	O	N
Full Wall Slide Out Awnings	O	O	O	O	O	O	O
Swing Out Brackets For Dually	O	O	O	O	O	S	S
Add-a-Step	O	O	O	O	O	O	O
LP Barbeque	O	O	O	O	O	O	O
4-way Remote Power Jacks	S	S	S	S	S	S	S

**KEY:** S Standard (no charge) O Option Available on Request N Not Available in this Model

## Approximate Overall Weight and Measure Specifications For Arctic Fox Campers:

Description	Arctic Fox Truck Campers (*) Designates NON Slide-out						
	811	865*	990	992	1140	1150	1160
Model Number	811	865*	990	992	1140	1150	1160
Dry Weight Extended Cab Lbs.	3468	3236	3605	3830	4060	3953	4436
Dry Weight Extended Cab Kgs.	1574	1468	1636	1738	1841	1793	2013
Width	96½"	96½"	96½"	96½"	96½"	96½"	96½"
Exterior Height	102"-112"w/air	102"-112"w/air	102"-112"w/air	102"-112"w/air	102"-112"w/air	102"-112"w/air	106"-114"w/air
Interior Height	79"	79"	79"	79"	79"	79"	75"
Floor Length	9' 0"	9' 4"	9' 10"	10' 2"	11' 4"	11' 4"	11' 6"
Overall Length	16' 8"	17'	17' 6"	17' 10"	19'	19'	19' 2"
Fresh Water w/Water Heater	45	34	55	47	55	55	47
Grey Water	41	32	44	29	44	44	53
Black Water	25	31	43	37	43	43	51
LPG Capacity (approx. gallons)	14	14	14	14	14	14	14

Weights include slide-out (if applicable). Some options are not included in the weights displayed. See the list of features that are included in the calculation below

### Approx. Weight of Additional Features

Feature	Est. Weight	
	Lbs.	Kgs.
Weight Unit of Measure	Lbs.	Kgs.
OHD Bunk	40	18
Swing Out Brackets	21	10
11M BTU Air Cond.	90	41
Solar Panel 50W	22	10
Solar Panel 100W	32	15
Removable Carpet	10	5
Side Box Awning	63	29
Generator Ready	25	11
2.5 Generator	78	35
Barbeque	22	10
One Battery	30	14
Typical Water Full (8.3 Lb/Gal)	458	208
Propane Full	60	27

Use these figures to estimate the total weight of the coach with added options:  
...camper weight + options

### All Unit Weights Include These Features

Semi-Automatic Winterization System; LPG Leak, Smoke and CO Detectors; 60x80 Upgrade Inner Spring Mattress; Range Hood w/ Light and Exhaust Fan; Phone Jack; Ready for Solar and Satellite; Decor Coordinated Headboard and Bedspread; Large 3-burner Range w/ 22" Oven (16" on 1140 & 1160); DSI Gas Electric Water Heater with Insulated Porcelain Tank; 20 M BTU Auto Ignition Furnace with Thermostat Control; Kenwood A/M F/M Stereo CD Player and 25 Watt Speakers; Heavy-Duty Camper Tie Downs; Water Heater By-pass Valve; Fridge; Roof Rack and Ladder; Fiberglass Exterior; Microwave Oven; Fire Extinguisher; Exterior Shower; Sliding Pantry; Range Cover; Night Shades; Galley Skylight w/Shade; Power Jacks; TV Antenna; Fan Vent; Rear Awning

Northwood Manufacturing reserves the right to modify options, change feature availabilities and plan configurations at any time. Please note that weights are approximate and for estimation purposes only. Specifications and weights subject to change without notice.

Your Arctic Fox Camper Dealer



Northwood Manufacturing, 59948 Downs Rd., PO Box 3359, La Grande, OR 97850 - (541) 962-6274 - www.northwoodmfg.com - Arctic Fox

Photos, drawings, dimensions and weights are presented as accurate but may differ from current production models. We continually upgrade & improve our products and reserve the right to change any specifications without notice. Please see your authorized Northwood dealer for updated information.