

"The Original"

ARCTIC FOX



"Home is where you park it"

"The Fox has been our Home for the last three months in all kinds of weather and all kinds of roads and has performed magnificently."

John & Linda Ross, 990 owners



'Quality You Can See'

ARCTIC FOX



Riviera Dune - Model 990

For years, Northwood has been the industry leader in slide out truck campers and this year is no exception! Like all Arctic Fox Campers, these new Foxes are durable enough for extended cross-country and off-road travel! Our transverse floor structure offers a wider main floor giving a spacious feel that is immediately apparent upon entering the coach. Check out the new features such as the comfortable and convenient Dream Dinette, with no table legs to negotiate around, and the new larger dinette window to enhance your view of the outdoors while dining or relaxing. Arctic Fox is the leader in slide out truck camper design.



Model 992

Typical Dry Bath



Model 990

Typical Wet Bath

"The Ultimate Back Porch" FOX LANDING

The new **FOX LANDING** offers a large entry platform, convenient fold away stairs and intermediate step for easy access. The stairway can be installed to the left or right of the landing, and the platform folds up, out of the way, for travel or when hitching your boat or trailer. Check it out!

- * 4 Equal Height Steps
- * Mid Step (Between Bumper & Threshold)
- * New Wider Bumper
- * Left or Right Hand Accessible
- * Glow Step Treads
- * Steps Fold Up in Seconds
- * Single Pin Locks Into Position
- * Built By Torklift...
- * **...Exclusively for Arctic Fox !!!**



1. Steps in the down position



2. Treads fold up....



3. Landing folds up, and pin locks it into place

Many manufacturers are building aluminum frame truck campers nowadays, but aluminum frames are not all the same. We are proud of the quality materials we use and the construction methods we employ to build America's best selling full wall slide out truck camper.

There's no doubt that our Arctic Fox truck campers are attractive, but what really sets us apart from the competition is how beautifully they're constructed. From our heavy gauge aluminum with continuous welded joints and solid fill anchor blocking, to our bonded full walk on roof (that will support 31 employees), the Arctic Fox Truck Camper is truly a thing of beauty. Once you've owned an Arctic Fox, you'll never be satisfied with less. That's why we say... "Beauty is more than skin deep!"

Northwood is pleased to introduce you to the Arctic Fox Truck Camper. With eight plans to choose from, there is an Arctic Fox to fit the needs of nearly every camper buyer. You can purchase your Fox Camper with confidence because Northwood builds more slide out truck campers than any other manufacturer! Arctic Fox offers a wide variety of features and options sure to satisfy your truck camper needs. That's because The Fox was designed with the informed camper purchaser in mind. We invite you to take a closer look and you'll see why Arctic Fox is the truck camper of choice for the experienced buyer.



Riviera Dune Model 811



Model 992



Royal Estate - Model 992

When you compare the specifications of our slide out with the competition, you will see why Arctic Fox continues to be the industry leader. Our full wall slides are up to 26" deep, and our aluminum super structure slide out operates under heavier load conditions than competitors. We build our slide outs right, using dual ram rack and pinion slide mechanisms. Many competitors rely on a single slide mechanism. The dual rams carry the slide-out room smoothly even under full load weights. Five separate seals ensure against water intrusion. The slide room is completely insulated for your comfort in all weather conditions. We will continue to lead the industry in innovative slide out camper engineering.



Royal Estate Model 992



Riviera Dune Model 865



Riviera Dune Model 990 - Panorama

Feature fabrics enhance the High Valley Maple finish hardwoods and textured wall boards. You have your choice of a number of beautiful interior decor colors. We use only commercial grade vinyl floor covering and you also have the option of a removable carpet kit. (Carpet kit not available in the 865 and 992 model.)

ARCTIC FOX



TV Indicates pre wired locations where TVs can be installed

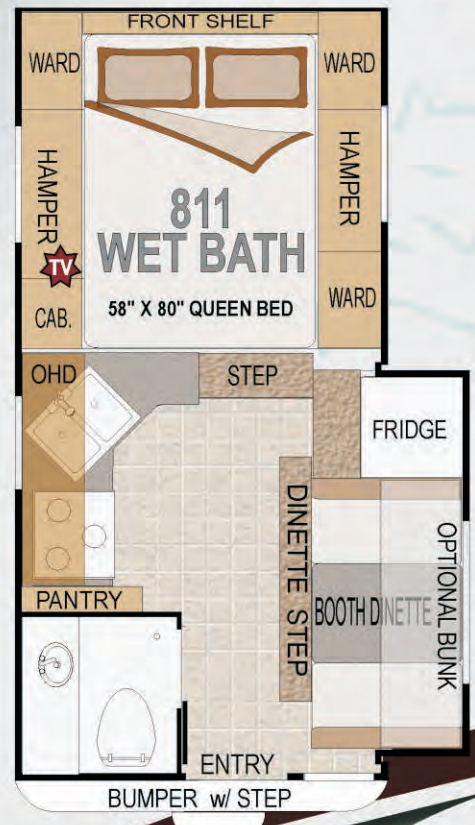
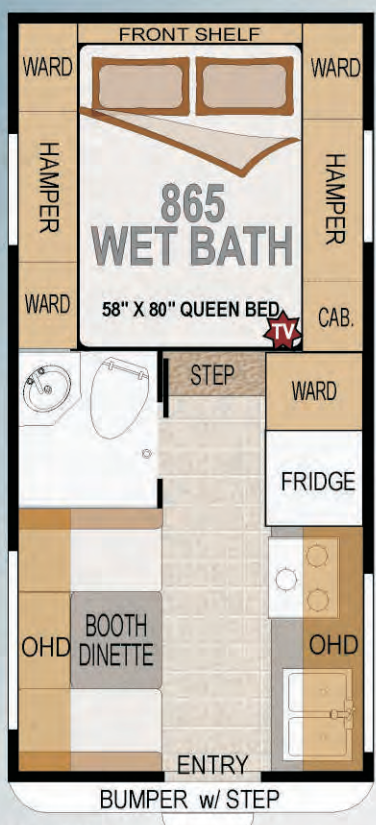

865 & 811 are available for 6 1/2' truck box or 8' truck box

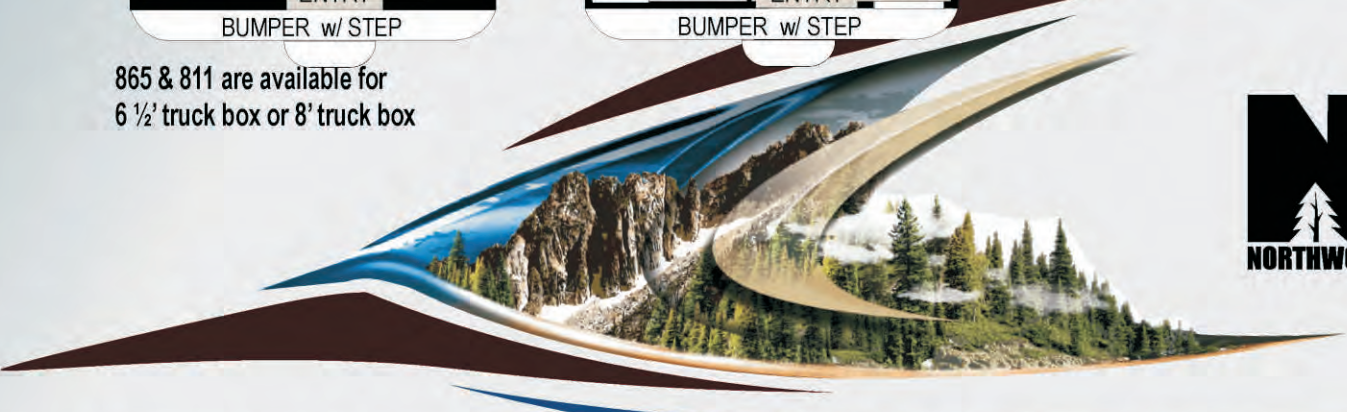

Approximate Overall Weight and Measure Specifications For Arctic Fox Campers:

Description	Arctic Fox Truck Campers (*) Designates NON Slide-out					
	811	865*	990	992	1140	1150
Model Number	811	865*	990	992	1140	1150
Dry Weight Lbs.	2873	2641	3010	3235	3465	3358
Dry Weight Kgs.	1303	1198	1365	1467	1571	1523
Width	96 1/2"	96 1/2"	96 1/2"	96 1/2"	96 1/2"	96 1/2"
Exterior Height	102"-112"w/AC	102"-112"w/AC	102"-112"w/AC	102"-112"w/AC	102"-112"w/AC	102"-112"w/AC
Interior Height	79"	79"	79"	79"	79"	79"
Floor Length	9' 0"	9' 4"	9' 10"	10' 2"	11' 4"	11' 4"
Overall Length	16' 8"	17'	17' 6"	17' 10"	19'	19'
Fresh Water w/Water Heater	45	34	55	47	55	55
Grey Water	41	32	44	29	44	44
Black Water	25	31	43	37	43	43
LPG Capacity (approx. gallons)	14	14	14	14	14	14

Weights include slide-out (if applicable). Some options are not included in the weights displayed. See the list of features that are included in the calculation table.

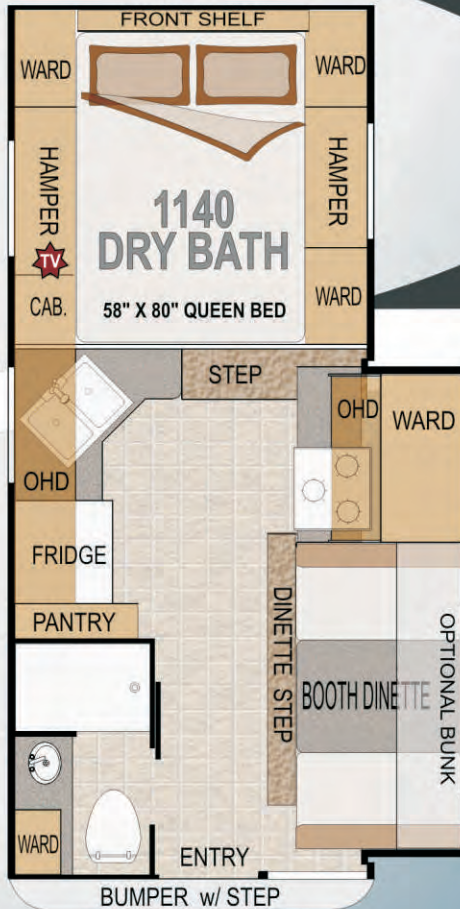

Features & Options



FOX VALUE PACK CONSTRUCTION

- Thermal Pane Windows
- Storm Windows
- Front Cab-Over Window

811 865 990 992 1140 1150

0	0	0	0	0	0
---	---	---	---	---	---

ELECTRICAL

- 50 Watt Solar Panel w/ Controller
- 100 Watt Solar Panel w/ Controller
- Combo Satellite Dish
- Auto Scan Satellite Dish
- 2.5 Onan Generator (Short Box Only 865 / 811)
- 11K BTU Air Conditioner

811 865 990 992 1140 1150

0	0	0	0	0	0
0	0	0	0	0	0
0	0	0	0	0	0
0	0	0	0	0	0
0	0	0	0	0	0
0	0	0	0	0	0

KITCHEN / GALLEY

- 2-way Double Door 6 Cu. Ft Fridge
- 2-way Double Door 8 Cu. Ft Fridge
- 3 Burner Range with 22" Oven
- 3 Burner Range with 16" Oven

811 865 990 992 1140 1150

0	0	0	0	0	0
N	N	N	N	N	O
0	0	0	0	N	O
N	N	N	N	O	N

PLUMBING & LAVY

- DSI Gas Electric Water Heater

811 865 990 992 1140 1150

S	S	S	S	S	S
---	---	---	---	---	---

INTERIOR

- LCD Flat Screen TV
- DVD Player
- Overhead Bunk in Dinette
- Full Wall Wardrobe
- Removable Livingroom Carpet

811 865 990 992 1140 1150

0	0	0	0	0	0
0	0	0	0	0	0
0	0	0	0	0	0
0	0	0	0	0	0
0	N	O	N	O	0

EXTERIOR

- Diamond Plate Front Panel
- Side Box Awning
- Full Wall Slide Out Awnings
- Swing Out Brackets For Dually
- Add-a-Step
- LP Barbeque
- Remote Power Jacks

811 865 990 992 1140 1150

0	0	0	0	0	0
0	0	0	0	0	0
0	0	0	0	0	0
0	0	0	0	S	S
0	0	0	0	0	0
0	0	0	0	0	0

KEY: **S** Standard Equipment (no charge)
O Option Available on Request
N Not Available in this Model

Full 12 Month Warranty (All Models)



Value Pack

Fox Value Pack is a mandatory option bundle that includes all of the following high value features:

- Rear Awning
- Sliding Battery Tray
- Rieco Titan[®] Electric Jacks
- Dual 30 lb. LP Tanks
- Exterior "Marine Speakers"
- Roof Rack and Ladder
- Sliding Storage "Joey" Tray
- Diamond Plate Armor- Basement Siding
- Large 22" Oven
- Microwave Oven
- LP/110 - 6 Cu Ft Dbl Door Refrigerator
- Pull-Out Pantry
- Deluxe Refrigerator Doors
- Fantastic Fan[®] - Multi-Speed/Reversible
- TV Antenna
- Dinette Storage Door
- Dinette Storage Drawer
- Bedspread/Shams
- Bedroom Front Shelf

Weight: 595 lbs.

Option Weights

Approximate weight of specific additional features:

Feature	Est. Weight	
Weight Unit of Measure	Lbs.	Kgs.
OHD Bunk	40	18
Swing Out Brackets	21	10
11M BTU Air Cond.	90	41
Solar Panel 50W	22	10
Solar Panel 95W	32	15
Removable Carpet	10	5
Side Box Awning	63	29
Generator Ready	25	11
2.5 Generator	78	35
Barbeque	22	10
One Battery	30	14
Typical Water Full (8.3 Lb/Gal)	458	208
Propane Full	60	27

Use these figures to estimate the total weight of the coach with added options: ...camper weight + options

Items Included In Unit Weight Estimation

All Unit Weights Include All of The Following Features Below: Fiberglass Exterior; Heavy-Duty Camper Tie Downs; Exterior Rinse Station; 20 M BTU Auto Ignition Furnace with Thermostat Control; 60x80 Pillow Top Inner Spring Mattress; Pre-wire for Solar and Satellite; Pre-wire for TV antenna; Pre-wire for microwave oven; Pre-wire for Air Conditioner; Large 3-burner Range; Range Cover; Range Hood w/ Light and Exhaust Fan; DSI Gas Electric Water Heater with Insulated Porcelain Tank; Water Heater By-pass Valve; Semi-Automatic Winterization System; Night/Privacy Shades; Galley Skylight w/Shade; 25 Watt Speakers; Fire Extinguisher; LPG Leak, Smoke and CO Detectors.

Northwood Manufacturing reserves the right to modify options, change feature availabilities and plan configurations at any time. Please note that weights are approximate and for estimation purposes only. Specifications and weights are subject to change without notice.

Camper Safety Tips

For your safety while driving, use mirrors that allow you to view past the camper to the rear on both sides. Trucks can be purchased with extended mirror options or you may purchase mirror extensions.

Truck manufacturers state that you should not exceed the GVRW for the vehicle that carries your camper. The configuration of your truck will determine what size camper your vehicle can carry. A dual rear wheel truck is advisable for Arctic Fox Campers over 10 ft.

Adjustable air bags will help to level your vehicle transfer rear axle weight forward

for comfort and safety and are recommended for all Arctic Fox applications.

Some states allow passengers to ride in the camper, but it is not recommended as there are no seat belts available.

When driving in any adverse weather condition it is always best to reduce your speed.

The pickup should be outfitted with a durable rubber mat liner to reduce shifting while traveling. The mat will also protect the truck bed and camper from scratching while loading and unloading.



Use **TORCLIFT** frame mounted camper tie downs for greatest safety.

ARCTIC FOX



111 Reasons To Buy An Arctic Fox



Construction

Aluminum Superstructure
Welded Aluminum Framing (.060" - .125")
2 lb. Virgin Block Foam Insulation
Full Walk-On Roof
Crowned Roof: 3-1/2" Tapered to 1-1/2"
Thick Seamless One Piece Roof Membrane
Transverse Floor Maximizes Floor Space
Continuous 1 Piece Fiberglass Cabover
Rack and Pinion Slide Out Mechanism



Exterior

LED Running Lights
LED Tail Lights - Recessed Automotive Style
Large 1" Thick, Insulated Compartment Doors
Metal Latches, Catches, and Pulls
Automotive Bulb Seals Around All Doors
12V Light in Termination Compartment
Removable 110V Power Cord (25' Length)
Outdoor High Pressure Rinse Station
5/8" Cast Iron Gas Manifold
Diamond Plate Armor Above Bumper
Entry Door w/ 2 View Windows
Aluminum Bumper w/ Dual Access
3 Position Step Mount
Entry Door/ Patio Light
Exterior Convenience Light (Non-slide Side)
Black Tank Flush
Exterior 110 Volt Outlets (GFI Protected)
Rain Gutters and Drip Spouts
LP Hookup for BBQ
White Frame Torque/Jalousie Windows
Large Tinted Safety Glass Windows
Thermal Pane Window Option



Bathroom

Fiberglass Shower Stall
Bathroom Skylight
Fold-Away Clothes Hanger
Vanity Cabinet & Mirror
Freeze Resistant Waterlines



Interior

High Valley Maple Cabinets
Face Frame Cabinet Construction
2 Interior Color Décor Choices
AM/FM CD Player w/ 6 Speakers
Rheostat Adjustable Lighting
Recessed Halogen Lighting
Wood Trim Accents
Ozite Ceiling Liner
2 Fluorescent Lights
Night/Privacy Shades
Direct Spark Ignition LP/110 Water Htr
Adjustable Heat Vents
Systems Monitor Panel
12 Volt Disconnect Switch
8 -110 Volt Outlets (9 -Dry Bath Models)
Large Capacity Holding Tanks
Enclosed Heated Holding Tanks
Enclosed Heater Termination Valves
Pre-Wired for Solar Panel
Pre-Wired for Satellite Receiver
Power Converter with Charger
Charge Wizard © Battery Maint. System
Generator Ready (Most Models)
Generator Transfer Switch (Most Models)
Optional Carpet Kit



Bedroom

Pillow Top, Inner Spring Mattress
19" LCD TV Option
Amplified TV Antenna Hookup
Park Cable Connection
110 Volt Outlets
12 Volt Outlet
Large Wardrobe Cabinet
Cabover Hampers
Swivel Accent Reading Lights
Mirrored Closet Doors
Padded Headboard
Full Wall Wardrobe Option
Optional Front Window



Kitchen

Galley Overhead Cabinets w/ Shelves
Solid Wood Doors
Full Extension Ball Bearing Drawer Glides
Single Lever Faucet w/ Pullout Sprayer
Counter Extension
Galley Backsplash
Large Kitchen Skylight w/ Shade
Beaufort Tough Designer Flooring



Slide Out

Full Wall Slide
26" Deep Slide (Most Models)
Oversized Dinette Window
Dream Dinette
Longer/Wider Dinette Table
Dinette Converts to 43 x 76 Bed
5 Seals on Slide-Out
Below Seat Storage
High Density Foam Seat Cushions
Optional Fold Down Ohd Bunk w/ Pad
Below Step Storage

FOX VALUE PACKAGE

Reico Titan © Electric Jacks (w/ Remote)
Large Rear Awning (7' x 8') Carefree ©
Sliding Storage "Joey" Tray
7 Gal LP Tanks (2 Stand-up)
Dual Battery Compartment w/ Slideout Tray
Diamond Plate Armor - Basement Siding
Roof Access Ladder
7" Tall Roof Rack
Rear Exterior "Marine" Speakers
3 Burner Hi-Output Range w/ 22" Oven (most models)
Microwave

6 CU FT. Refrigerator (LP/110)
Deluxe Refrigerator Doors
Dinette Storage Drawer
Dinette Storage Door
Pull-Out Pantry
TV Antenna
FANTASTIC © Reversible, Multi-Speed Fan
Coordinated Bedspread & Shams
Bedroom Front Shelf



Dual Rams - Dual Battery Rack - Dual LPG Tanks



Dual Ram Rack and Pinion
Slide Assembly in All Slide Outs



Sliding Dual Battery Tray
Holds **Two** Group 29 Batteries
420 Amp Total Capacity



Dual 30 LPG Tanks
w/Auto Change-over
Regulator

Thank you!

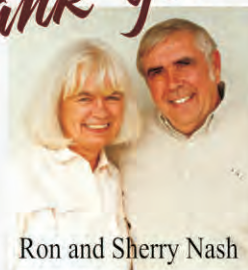

Ron and Sherry Nash

Thank you for taking a moment to check out our Northwood products. Our highest priority is to offer you the best combination of quality and value in an RV and we are confident you will appreciate and thoroughly enjoy your Northwood RV purchase for many years to come.



Our Guarantee of
**Quality
 Strength
 Durability**

Absolute Northwood

*"Where Quality is
 Everyone's Responsibility"*



Aluminum Superstructure & Solid Core Blocking

Aluminum Superstructure with Solid Core Anchor Blocking

Anchor blocking gives substantial strength at main connection points.



ALUMINUM SUPERSTRUCTURE
 Silver Fox Edition



Solid Core Anchor Blocking

CONTINUOUS BEAD WELDS
 ALL THREADS ARE SECURING THE FASTENER



other brands

SPOT WELDS

ONLY ONE OR TWO THREADS ARE SECURING THE FASTENER

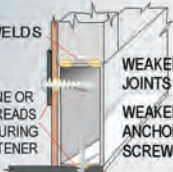

WEAKER JOINTS
 WEAKER ANCHOR SCREWS

Structural Aluminum Basement Floor Frame



Tubular Aluminum Truss Basement Floor Frame

Big holding tanks require a 'Big' floor structure...
That's the Arctic Fox floor!
 Thick wall aluminum basement floor joists support our holding tanks under the basement of every Arctic Fox Truck Camper.



The foundation walls of a Northwood Truck Camper are the thickest in the industry!

We use 1-1/4" thick plywood for the strongest basement wall you will find anywhere! A structure is only as good as its foundation, and we build on the best.



Your Local Dealer is:

Sept 2011

Full Walk On Roof - 31 Employees On Board!



Now that's an ABSOLUTE FULL walk-on roof!

When Northwood advertises a "Full Walk-On Roof" for our slide out truck campers, you not only can walk everywhere on the roof, but you could also invite a couple dozen of your friends to join you!
 We tested the strength of our 992 full-wall slide model by loading the roof with 31 of our camper line employees (a good testimonial for our camper jacks too!).

Solid Wood Cabinetry

4 Season All Weather Camper



By using solid wood face frame construction and then integrating the cabinet with the structure of the ceiling and walls, our coaches and our cabinets are both made stronger.

Heated Holding Tank Area

Our fully enclosed, insulated and heated holding tank area circulates air around the suspended tanks providing the best protection from freezing. All our dump valves are also enclosed and heated to ensure smooth operation, even in cold northern climates.

PO BOX 3359
 59948 Downs Road
 La Grande, OR 97850



Phone 541.962.6274
 Fax 541.963.4392
 www.northwoodmfg.com